

型号WE系列湿式电磁换向阀以电磁铁控制的换向滑阀, 用作控制工作油液的开启, 停止和工作油液的流动方向。

特性:

1. 标准面板安装, 可互换
2. 湿式直流或交流电磁铁可选择, 线圈可方便拆卸
3. 手动应急操作

Model WE series are directional spool valves, they control the direction, start, stop of flow, with characteristic of low switching noise, great performance, easy coil connection, replacement and standard mounting.

Characteristic:

1. Standard subplate mounting allows 100% interchangeable
2. Minimum pressure loss, great operating performance
3. Plug-in coil for easy replacement with different voltage



FT - 4 WE 6 E 60 / G24 N /

3 = 3工作油口 3 = 3-way
4 = 4工作油口 4 = 4-way

通径 Size 6, 10

阀芯机能符号见附表

E (or F, G etc.) = Spool function, please check the function symbols

系列号 Series no.

60 = 通径6 60 = Size6
30 = 通径10 30 = Size10

无标记 = 弹簧复位

No code = With spring

O = 无弹簧复位

O = Without spring

OF = 无弹簧复位, 带定位机构

OF = With detent, without spring

G24 = 直流24V; G12 = 直流12V

W220 = 交流220V; W110 = 交流110V

G24 = DC24V; G12 = DC12V (Direct current)

W220 = AC220V; W110 = AC110V (Alternating current)

N = 带手动按钮

无标记 = 不带按钮

N = With manual override (s)

No code = Without manual override

无标记 = 表面磷化 (黑色), 镀铬电磁铁 (亮色)
F2 = 喷漆塑 (蓝色), 电磁铁表面磨砂 (亚光)

No code = Phosphate treatment (black)

-with chromeplate surface coil (s)

F2 = Spraying plastics (blue)

-with matte finished surface coil (s)

Note: Please check our web for colors

无标记 = 丁腈橡胶密封

V = 氟橡胶密封

No code = NBR seals for petroleum oils

V = FPM seals for phosphate ester

无标记 = 无插装节流塞

B08 = 节流孔0.8 mm, B10 = 节流孔1.0 mm

B12 = 节流孔1.2 mm

No code = Without orifice insert

B08 = Orifice size 0.8 mm, B10 = Orifice size 1.0 mm

B12 = Orifice size 1.2 mm

Z5L = Angled plug and light(s) Z5L = 方型带灯插头

General information 基本参数		6	10
通径 Size		6	10
最高工作压力 Max. Operating Pressure (MPa)	A, B, P 油口 A, B, P (Ports) T 油口 T (T Port)	31.5 16	31.5 16
最大流量 Max. Flow Rate (L/min)		60	120
直流可用电压 Available Voltage DC		12V, 24V	
交流可用电压 Available Voltage AC		110V, 220V (50/60Hz) *电器保护导线请按(PE) 规定接地 *The earth line be connected as per PE	
油液清洁度 Fluid Contamination		油液最高污染按 NAS1638, 第9级 推荐过滤器精度 $\beta_{10} \geq 75$ Max. allowed degree of contamination is to NAS1638 Class9 Recommend: A filter with a minimum filtrating rate of $\beta_{10} \geq 75$	

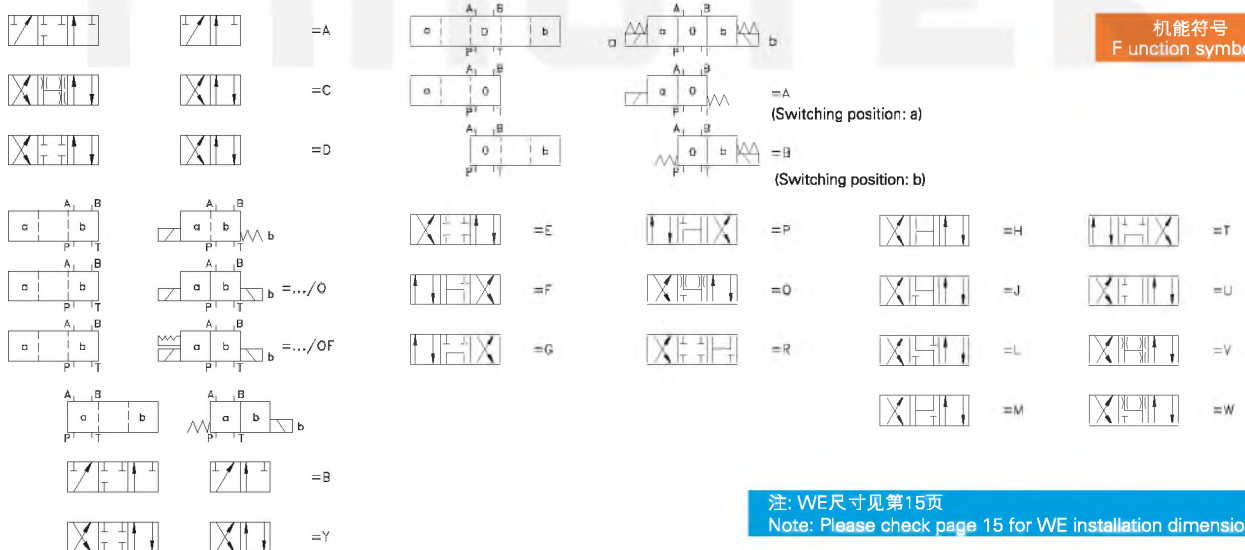

机能符号
Function symbols

注: WE尺寸见第15页
Note: Please check page 15 for WE installation dimensions

WE6 Installation dimensions

安装尺寸

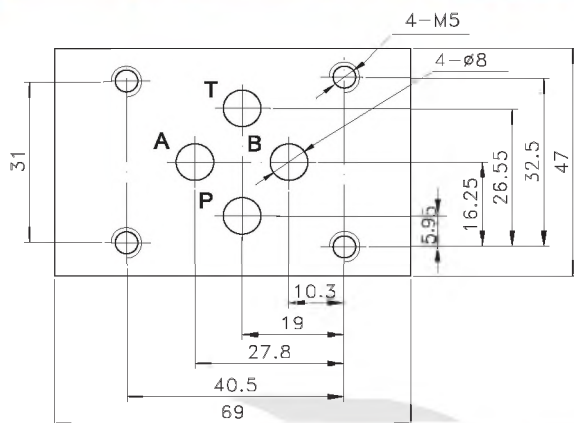

安装尺寸

WE10 Installation dimensions

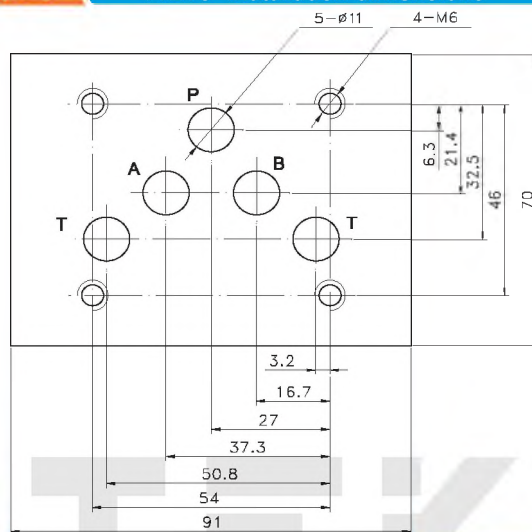

注：尺寸与以下型号相同

Note: The dimensions are the same with the code below, WDG6 ,Z1S6 ,Z2S6 ,Z2FS6 ,WMM6 ,ZDB/Z2DB6 ,ZDR6 ..D

注：尺寸与以下型号相同

Note: The dimensions are the same with the code below, WDG10 ,Z1S10 ,Z2S10 ,Z2FS10 ,WMM10 ,ZDB/Z2DB10 ,ZDR10..D