

Cartridge Valve Housing

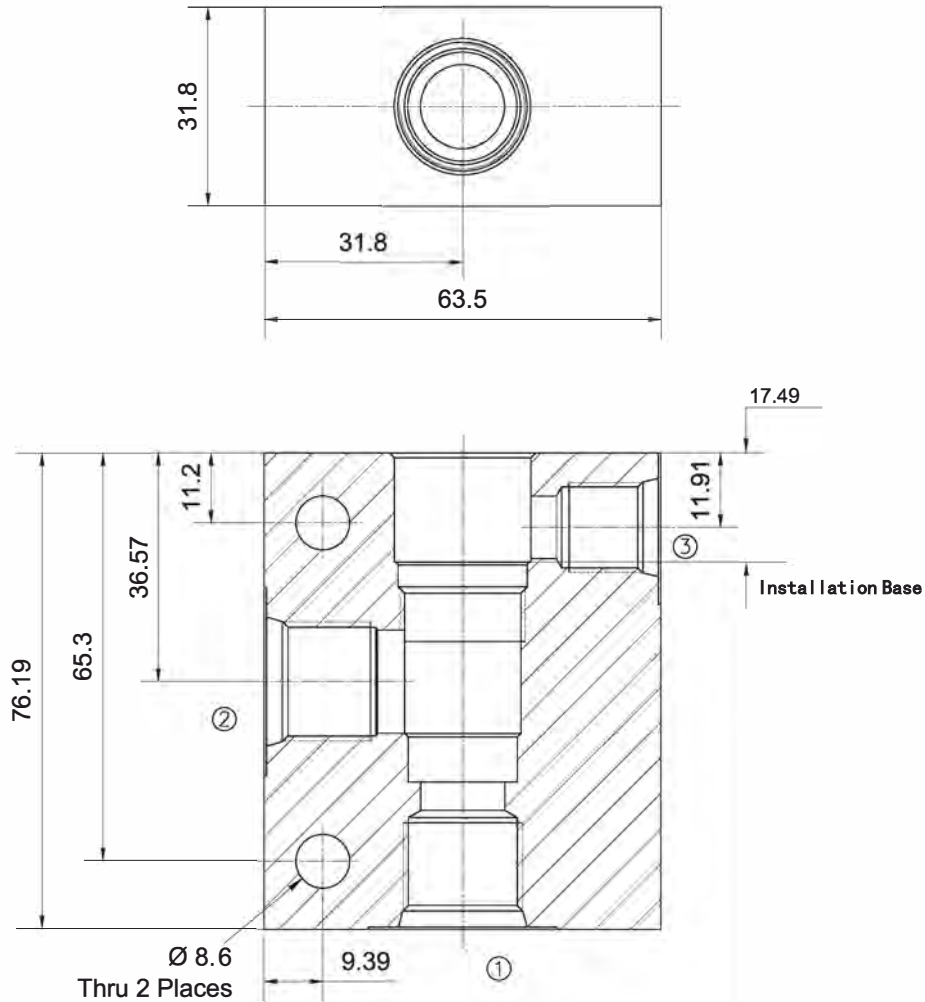

Series T-11A Housing



Unit=Millimeters

Part No.	Ports 1 & 2	Port 3
LECA	1/4" NPTF	1/4" NPTF
LECB	3/8" NPTF	1/4" NPTF
LECC	1/2" NPTF	1/4" NPTF
LECH	SAE 4	SAE 4
LECI	SAE 6	SAE 6
LECJ	SAE 8	SAE 6
LECK	SAE 10	SAE 6
LECT	G 1/4	G 1/4
LECU	G 3/8	G 1/4
LECV	G 1/2	G 1/4

Material	Operating Pressure	Part No.
Aluminum, 6061-T6	210 bar (3000 psi)	****
Steel	350 bar (5000 psi)	****-S